

Sound Insulation Index ISO 140-3:1995

Laboratory measurement of airborne sound insulation
Sponsor: Sauerland Spanplatte

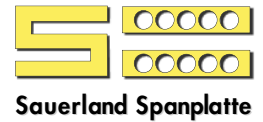

Internal Test

Construction of the test specimen:

- Door leaf 900 x 2010 x 39,6 mm, sealed
- 1 : Solid particle board 33 VL
- 2 : Hardboard 3 mm
- 3 : Hardwood 45 mm

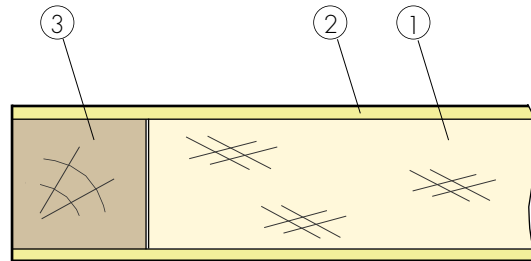

Test opening: 2,00 m²

Weight of test specimen: 24,13 kg/m²

Temperature [°C]: 18

Humidity [%]: 56

Source room volumes: 72 m³

Receiver room volumes: 70 m³

frequency [Hz]	R [dB]
50	-.-
63	-.-
80	-.-
100	20,0
125	24,4
160	28,9
200	26,5
250	28,5
315	30,6
400	30,3
500	29,1
630	29,9
800	29,7
1000	28,5
1250	30,4
1600	31,3
2000	33,6
2500	35,9
3150	38,3
4000	40,5
5000	41,9

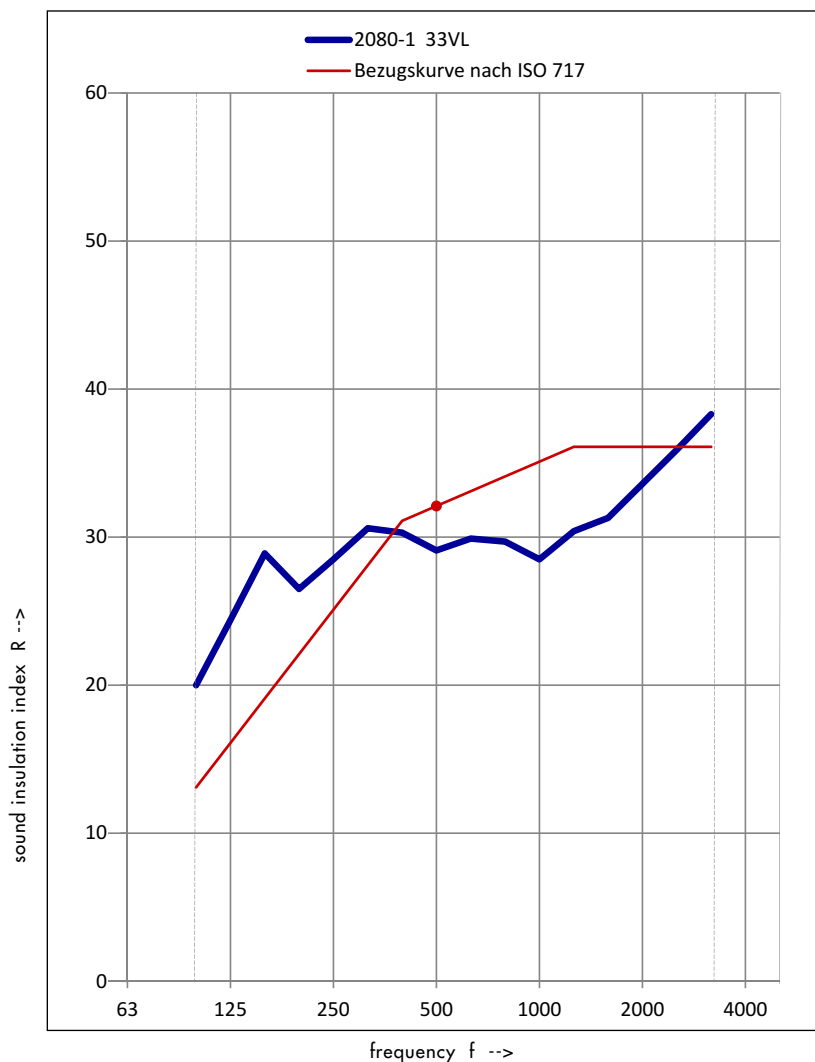

Airborne sound

insulation $R_{WV} (C, C_{tr}) = 32 (-1; -2,5) \text{ dB}$

C50_3150: - C50_5000: - C100_5000: -0,1

Ctr50_3150: - Ctr50_5000: - Ctr100_5000: -2,5

Sauerland-Service-Centre

Order number: 2080/2002

Gotha, 22.10.2002